

(1) SMR Code	(2) Federal Stock Number	(3) Description	(4) Unit of Meas.	(5) Qty	(6) 15-day Maintenance In	(7) Organizational allowance Illustration	(a) Figure No.	(b) Item No.
Reference number & mfg. code			Usable on code		(a) 1-5	(b) 6-20	(c) 21-50	(d) 51-100
2001-HOIST, WINCH, CRANE ASSEMBLY -CONTINUED								
PAOZZ	5310-732-0560	NUT,PLAIN,HEXAGON:CONTROL BOX ROD AND CONNECTING CLEVIS MS51968-14 (96906)	AK	EA	1	* * * *	180	10
PAOZZ	5315-839-5822	PIN,COTTER: MS24665-353 (96906)	AK	EA	3	* * * *	180	11
PAOZZ	5315-889-2776	PIN,STRAIGHT,HEADLESS: MS35672-44 (96906)	AK	EA	2	* * * *	180	12
PAOZZ	4730-050-4208	FITTING,LUBRICATION:1/8 NPT, CONTROL ROD AND SHAFT MS15003-1 (96906)	AK	EA	4	* * * *	180	13
PAOZZ	2520-482-2445	SHAFT:DUMP CONTROL POWER TAKEOFF CONNECTING ROD MOTION TRAVERSE 8758690 (19207)	AK	EA	1	* * * *	180	14
PAOZZ	2590-351-7833	ROD ASSEMBLY:DUMP CONTROL POWER TAKEOFF CONNECTING 8758687 (19207)	AK	EA	1	* * * *	180	15
XBOZZ		ROD: DUMP CONTROL POWER TAKEOFF CONNECTING 8758688 (19207)	AK	EA	1		180	16
PAOZZ	5315-846-1270	PIN,CLEVIS: MS35810-35 (96906)	AK	EA	1	* * * *	180	17
PAOZZ	5315-842-3044	PIN,COTTER: MS24665-283 (96906)	AK	EA	1	* * * *	180	18
PAOZZ	4730-045-9771	PLUG,PIPE:1/2-14NPT, HYDRAULIC FLUID TANK PIPE COUPLING MS490006-8 (96906)	AK	EA	1	* * * *	181	1
PAOZZ		SCREEN ASSEMBLY: FLUID TANK 7409025 (19207)	AK	EA	1	* * * *	181	2
PAOZZ	5365-182-9635	WASHER:HYDRAULIC TANK FILLER 7409080 (19207)	AK	EA	1	* * * *	181	3
PAOZZ	2590-740-9026	GAUGE ASSEMBLY:FLUID TANK LIQUID LEVEL 7409026 (19207)	AK	EA	1	* * * *	181	4
PAOZZ		PLUG:HYDRAULIC FLUID TANK FILLER 7409027 (19207)	AK	EA	1	* * * *	181	5
PAOZZ	4730-172-0034	FITTING,LUBRICATION:CONTROL BOX LEVER MS15003-6 (96906)	DA,CC,CD,DB	EA	1	* * * *	182	1
PAOZZ	5305-267-8974	SCREW,CAP,HEXAGON HEAD:LEVER RETAINING MS90726-8 (96906)	DA,CC,CD,DB	EA	1	* * * *	182	2
PAOZZ	2520-740-9094	LEVER,REMOTE CONTROL: 7409094 (19207)	DA,CC,CD,DB	EA	1	* * * *	182	3
PAOZZ	5310-582-5965	WASHER,LOCK: MS35338-44 (96906)	DA,CC,CD,DB	EA	1	* * * *	182	4
PAOZZ	5310-768-0319	NUT,PLAIN,HEXAGON:CONTROL BOX LEVER MS51968-2 (96906)	DA,CC,CD,DB	EA	1	* * * *	182	5

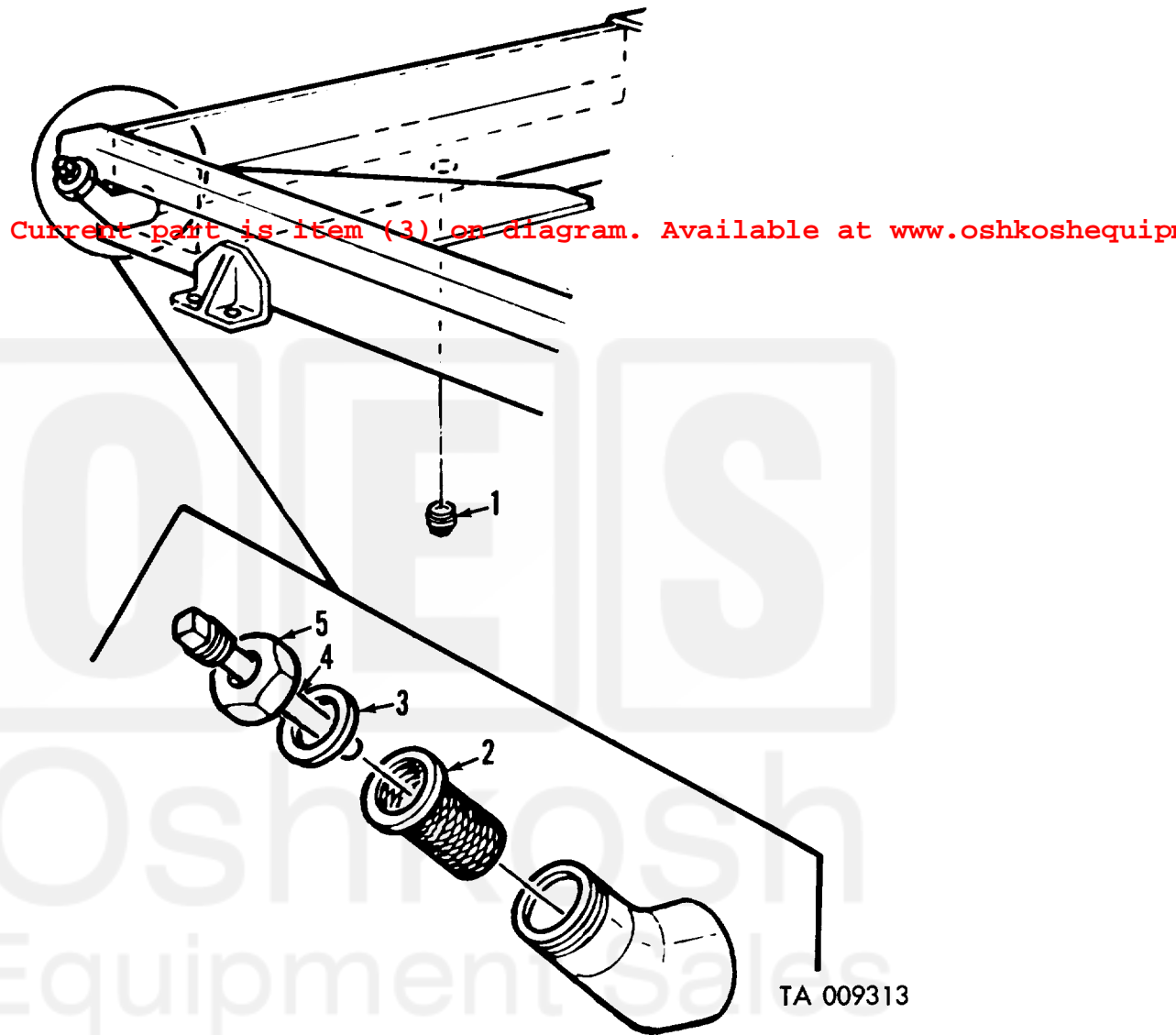

Figure 181. Dump truck oil gage.